

## THERMASHEATH® EXTERIOR DUCTWORK APPLICATION

---

Rmax Thermasheath® is suitable for use on the exterior side of existing ductwork. When the ductwork is solely on the exterior of the building, the insulation need only be protected from the outside weather conditions. As an example, this can be done with a waterproofing membrane installed per the manufacturer's recommendations.

Refer to Thermasheath® Product Data Sheet for additional application/installation, compliances, thermal and physical properties, limitations and warnings.

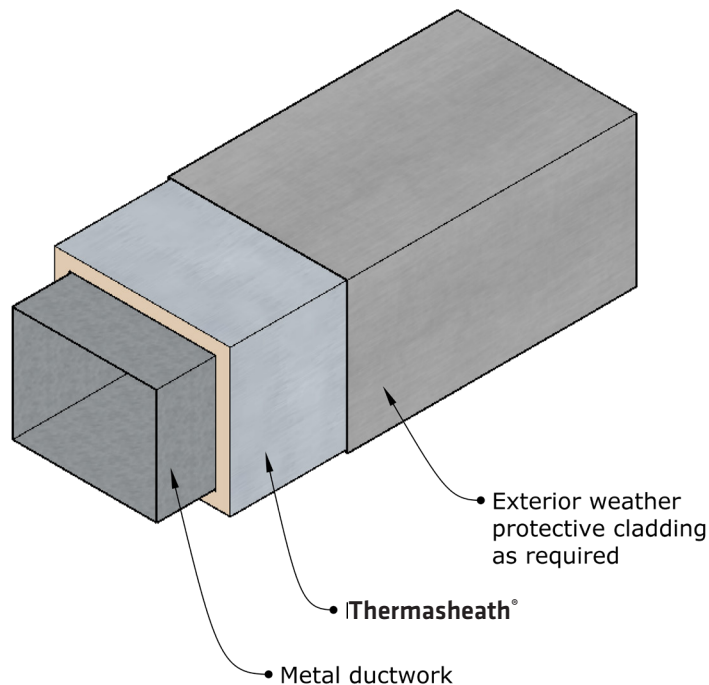

---

Warranty: See Rmax "Sales Policy" and "Fifteen Year Limited Thermal Warranty" for terms and conditions. Rmax does not assume any responsibility or liability for the performance of any products other than those manufactured by Rmax. **NOTE: All Rmax products must be tarped, placed on skids and kept dry before and throughout construction.**

---



BUILDING TRUST



PRODUCT APPLICATION SHEET  
THERMASHEATH®  
Revision.02-27-2020  
www.rmax.com  
(800) 527-0890